

SPECIFICATIONS

OUTLINE DRAWING

AO Medium	TeO <sub>2</sub>
Acoustic Mode	Longitudinal
Acoustic Velocity	4.20 mm/μs
Wavelength	1066-1100 nm
Input Polarization	Linear
Output Polarization	
Insertion Loss	<3%
Center Frequency (Fc)	75 MHz
RF Bandwidth	32MHz, Goal 40MHz
RF Power	4W max.
Active Aperture	2.5 mm dia.
Average Diffraction Efficiency	N/A
Intensity Variation Across Bandwidth	N/A
Min Diffraction Efficiency	70%
Peak Valley at 633 nm	N/A
RMS at 633 nm	N/A
VSWR	2.0:1
Scan Angle	N/A
Time Bandwidth	N/A

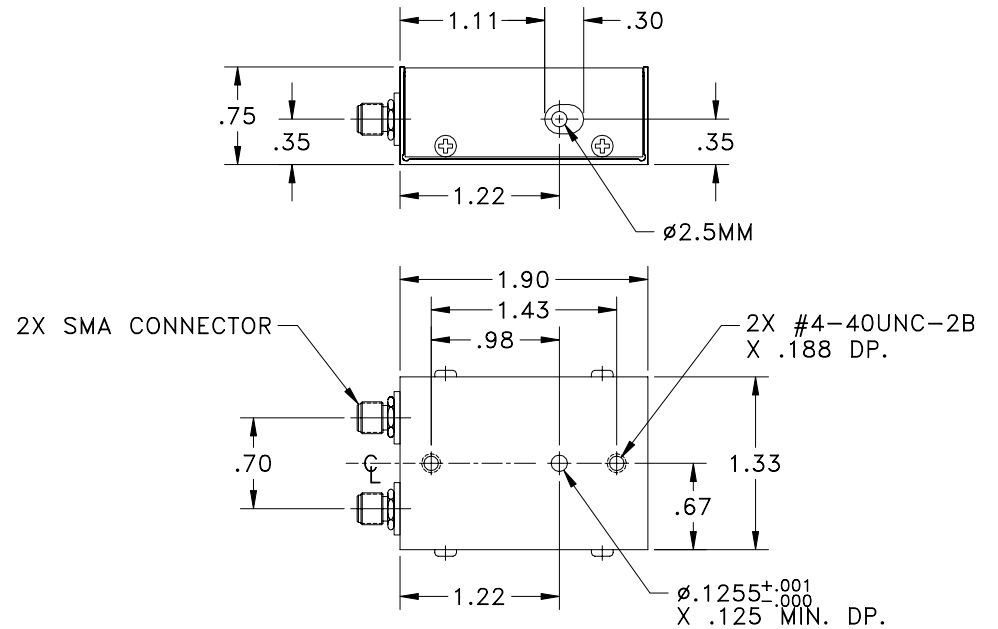

Notes:

1. Input Impedance is 50 Ohms.
2. Electrode: Two Element Phased Array
3. RoHS Compliant

Document

01/25/08

Control

THIS DOCUMENT IS THE PROPERTY OF CRYSTAL TECHNOLOGY, INC. IT IS NOT TO BE REPRODUCED OR DISCLOSED IN WHOLE OR IN PART OTHER THAN BY EMPLOYEES OF CRYSTAL TECHNOLOGY AND ITS CONTRACTED REPRESENTATIVES AND DISTRIBUTORS. ANY EXCEPTION REQUIRES THE WRITTEN CONSENT OF AN AUTHORIZED REPRESENTATIVE OF CRYSTAL TECHNOLOGY.

TOLERANCES: .XX ± .01 .XXX ± .005	DR	Gerl Scholz 1/23/2008	<b>Crystal Technology, Inc.</b>
MATERIAL:	CHK		
	APP		
	APP		PART NUMBER: <b>97-02823-52</b>
			REV: <b>B</b>
			SHEET 1 OF 1